

**SHERLINE  
PRODUCTS**  
INCORPORATED 1974

## Tilting Angle Table for Laser Engraving

P/N 3750-LAZ

### About the Laser-Engraving Tilting Angle Table

We came up with the concept of this tilting angle table for laser engraving because we realize that most laser engraving shops don't have access to a machine shop that can make special fixtures for their parts. Most laser engraving shops have an assortment of blocks, and pins, and shims that they will use to build a "less than accurate" setup to hold parts on an angle.

This accessory offers a great variety of setup options. It was designed to accept several of our other laser engraving accessories, such as our CNC rotary table (P/N 8730) and our 3-jaw chuck with pin jaws (P/N 1140). The table also has (66) "dual purpose" 3/16" holes. These holes are reamed on the top half to accept 3/16" steel dowel pins (for locating parts), and tapped 10-32 on the bottom half so you can use hold-down clamps. The tilting angle table includes the following:

- (2) Hold-down clamp sets include:
  - (2) Hold-down clamps
  - (2) 10-24 1-1/4" Carriage bolts
  - (1) 10-32 7/8" Socket head cap screws
  - (1) 10-32 1-1/4" Socket head cap screws
  - (2) 3/16" I.D. washers
- (6) 3/16" x 1/2" steel dowel pins
- (6) 3/16" x 1" steel dowel pins
- (1) Tilting angle table 3/4-16 chuck hold down

The table can be set at any angle from 0° to 90° in order to hold your part with the tapered surface perpendicular to the laser beam. The tilting angle table can be clamped to any flat surface or held in a vice. The base also has a hole pattern so it can be mounted easily to our Laser Engraving Plate & XY Slide w/18" Table (P/N 6540LAZ).

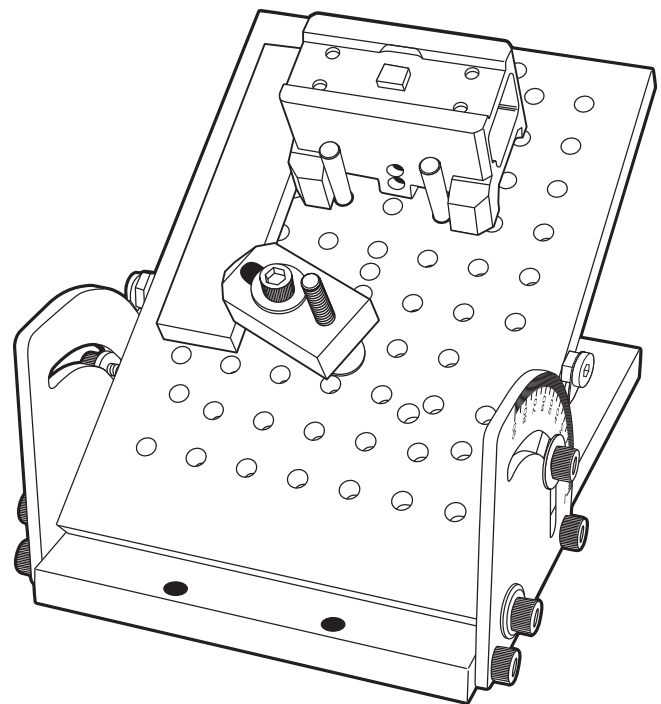

FIGURE 1—Shows part being held with dowel pins, and a hold-down clamp securing a metal bar.

### Maintenance

The angle graduations are laser engraved into the stainless steel side plates so you don't have to worry about rust or solvents. Do not try to polish around the engraving. Though quite easily readable, it is not very deep and could be removed in the polishing process.

Thank you,  
Sherline Products Inc.

# P/N 3750-LAZ Tilting Angle Table for Laser Engraving

## Exploded View and Parts Listing

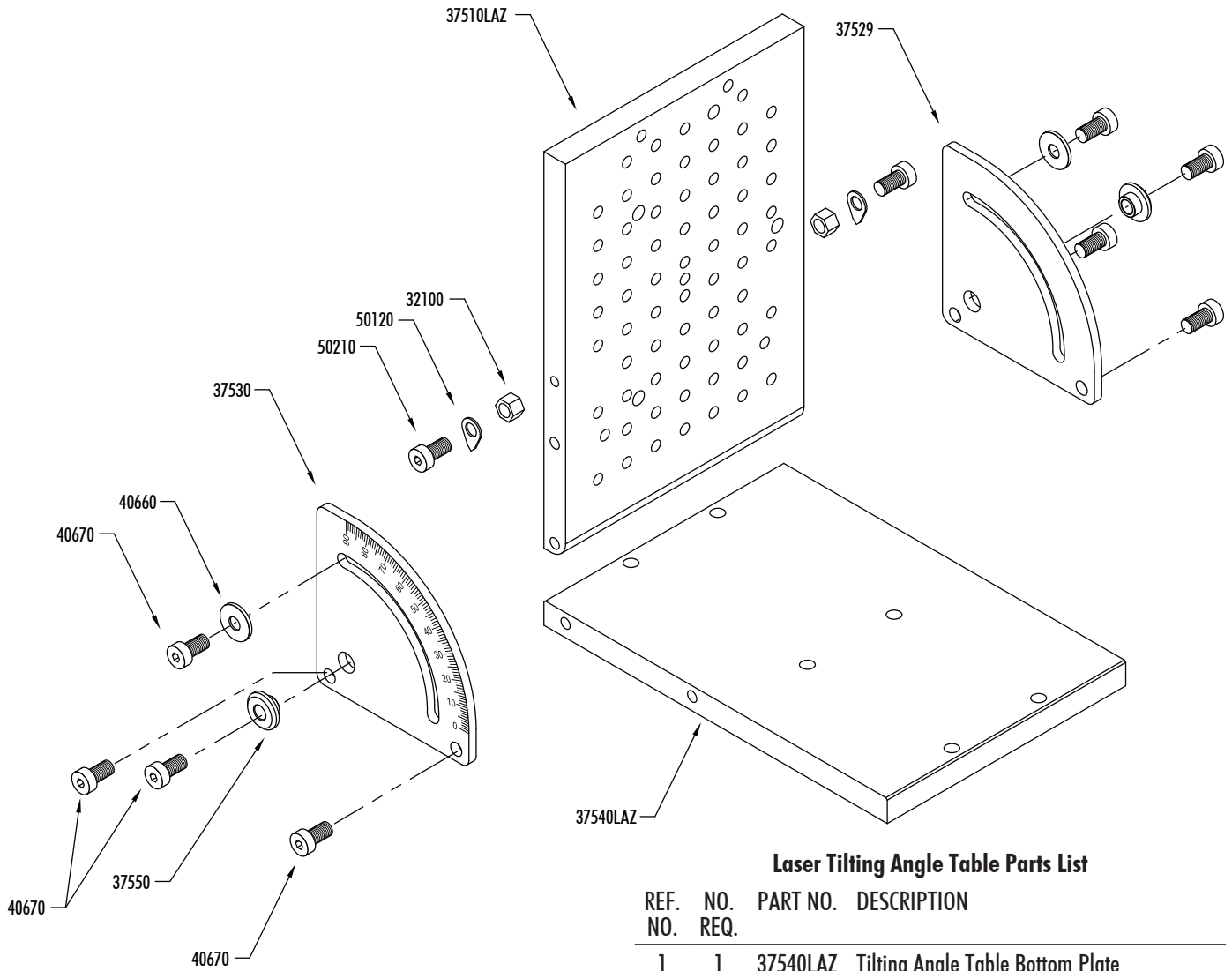

### Laser Tilting Angle Table Parts List

REF. NO.	NO. REQ.	PART NO.	DESCRIPTION
1	1	37540LAZ	Tilting Angle Table Bottom Plate
2	1	37510LAZ	Tilting Angle Table Top Plate
3	1	37529	Tilting Angle Table Side Plate, Engraved (lt)
4	1	37530	Tilting Angle Table Side Plate, Engraved (rt)
5	2	37550	Tilting Angle Table Bushing
6	1	37560	Tilting Angle Table 3/4-16 Chuck Hold Down
7	11	40670	10-32 x 1/2" SHC Screw
8	2	40660	3/16" I.D. Washer
9	2	50120	Pointer
10	2	32100	10-32 Hex nut
11	2	50210	8-32 X 1/4" Phillips Head Screw
12	6	37570	3/16 " x 1/2" Steel dowel pins
13	6	37580	3/16 " x 1" Steel dowel pins

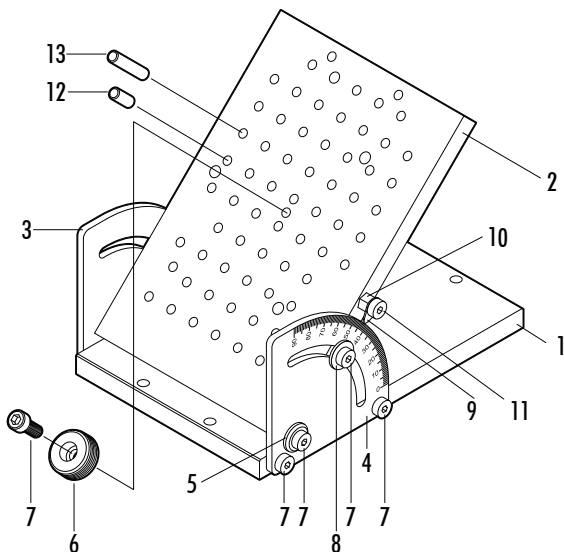

### Hold-Down Clamp Set Parts List (Not shown)

NO. REQ.	PART NO.	DESCRIPTION
2	35580	Hold-down clamp
2	30140	10-24 1-1/4" Carriage bolt
1	40740	10-32 7/8" SHC Screw
1	40710	10-32 1-1/4" SHC Screw
2	40660	3/16" I.D. washer